

General information

PVS26620220120

MKX is a mounting accessory invented by Pavone Systems, who developed this product thanks to his previous experience and know-how. This is an innovative mechanical system for mounting load cells for industrial weighing systems. The kit can be easily adjusted for both radial and tangential assembly. MKX does not hinder the normal expansion and contraction movements of the weighing structure and it allows the weighing structure to be lifted by itself without the aid of a jack. Furthermore, it is excellent as a template for the assembly mechanics of a weighing system. The MKX accessory stands out from the others because: it is possible to adjust it in height and this allows to reach the perfect flatness, the lower base and the upper base are connected and fixed and this ensures correct installation and perfect perpendicularity, it also works as anti-tilting and finally, it is able to absorb the lateral forces thanks to the ball cup attached to the base of the cell on which the load is unloaded. The mounting kit MKX is available in alloy steel or in stainless steel AISI 304 and can be used with our load cells: 65023 (with capacity 125÷250 kg, 300÷2000 kg, 3000÷5000 kg), 65083 (with capacity 300÷2000 kg and 3000÷5000 kg), SB (with capacity 75÷250 kg), SBR (with capacity 300÷2000 kg, 3000÷5000 kg and 7500÷10000), BBR (with capacity 5÷500 kg) and BBF (with capacity 15÷1500 kg).

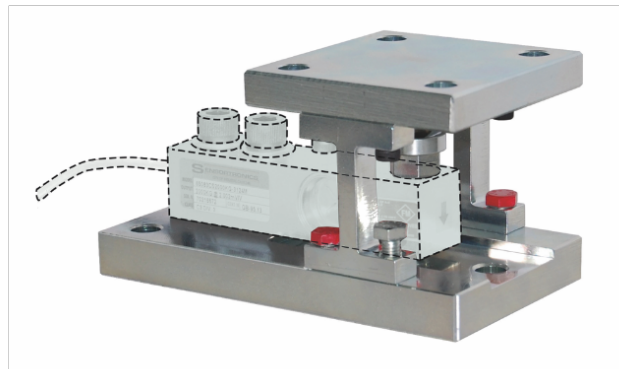

Suggested related products

A highly performing weighing system must be accurate, perfectly calibrated and well maintained. In order to improve the load cell performance and to optimize its functioning, you may need the following products:

Weight Transmitter [DAT 1400](#)

Weight Indicator [MCT 1302](#)

Mounting kits [MH MOUNTING KIT](#)

Shear beam load cells [65023](#)

Shear beam load cells [SBR](#)

All indicated data may be changed without notice.
All the measures indicated are expressed in millimeters (mm).

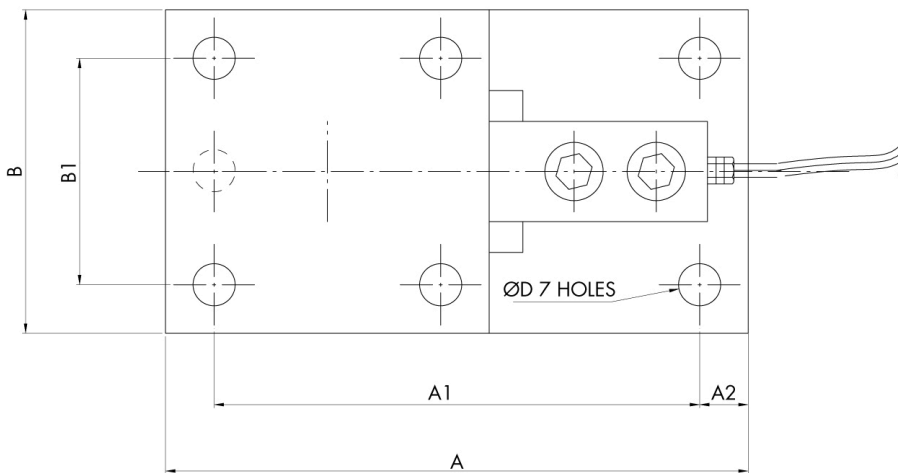
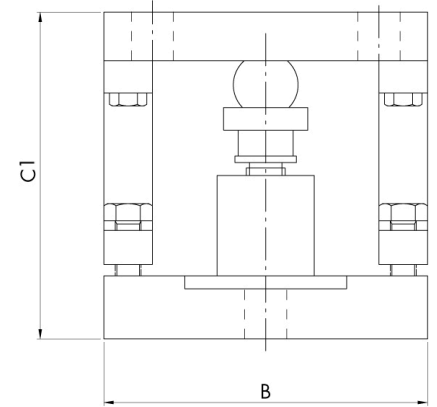
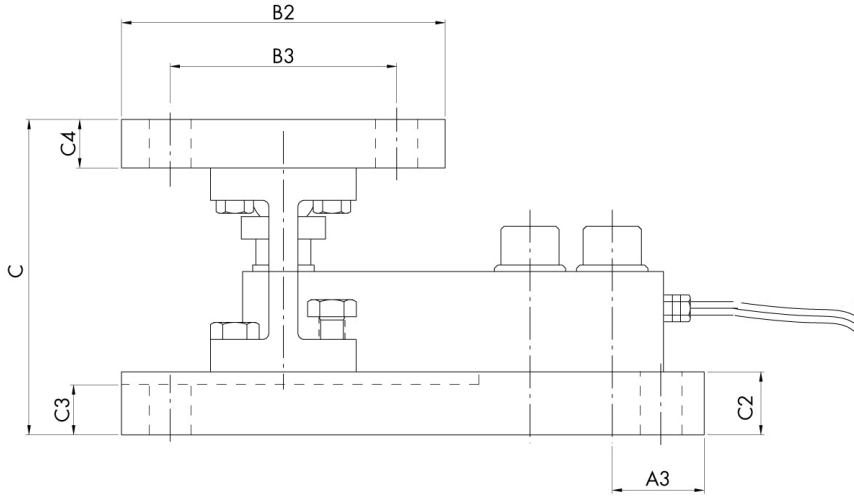
ALLOY STEEL (capacity, dimensions and maximum load values by model)

| KIT | KG | A | A1 | A2 | A3 | B | B1 | B2 | B3 | C | C1 | C2 | C3 | C4 | ØD | COMPRESSION | TILT | SIDE LOAD |
|-------------|------------|-----|-----|----|------|-----|-----|-----|-----|-------|-------|------|------|------|----|-------------|----------|-----------|
| MK0 | 75÷250 | 180 | 150 | 15 | 28,4 | 100 | 70 | 100 | 70 | 97,5 | 100,5 | 19,5 | 15,5 | 15 | 13 | 10540 kg | 6820 kg | 2100 kg |
| MK1 | 75÷250 | 180 | 150 | 15 | 28,4 | 100 | 70 | 100 | 70 | 97,5 | 100,5 | 19,5 | 15,5 | 15 | 13 | 10540 kg | 6820 kg | 2100 kg |
| MK2 | 300÷2000 | 180 | 150 | 15 | 28,4 | 100 | 70 | 100 | 70 | 97,5 | 100,5 | 19,5 | 15,5 | 15 | 13 | 10540 kg | 6820 kg | 2100 kg |
| MK3 | 3000÷5000 | 250 | 210 | 20 | 41,6 | 150 | 110 | 150 | 110 | 136,5 | 140 | 29,5 | 24,5 | 20 | 18 | 24440 kg | 18810 kg | 5750 kg |
| MK4 | 3000÷5000 | 250 | 210 | 20 | 41,6 | 150 | 110 | 150 | 110 | 146,5 | 150 | 29,5 | 24,5 | 20 | 18 | 24440 kg | 18810 kg | 5750 kg |
| MK6 | 5÷500 | 180 | 150 | 15 | 30 | 100 | 70 | 100 | 70 | 97,5 | 100,5 | 19,5 | 13,5 | 15 | 13 | 6470 kg | 4280 kg | 1580 kg |
| MK7 | 15÷1500 | 180 | 150 | 15 | 22,5 | 100 | 70 | 100 | 70 | 97,5 | 100,5 | 19,5 | 8,5 | 15 | 13 | 6470 kg | 4280 kg | 1580 kg |
| MK10 | 7500÷10000 | 300 | 260 | 20 | 28,3 | 200 | 160 | 200 | 160 | 184 | 190 | 39,5 | 39,5 | 24,5 | 22 | 38340 kg | 27300 kg | 11500 kg |

All indicated data may be changed without notice.
All the measures indicated are expressed in millimeters (mm).

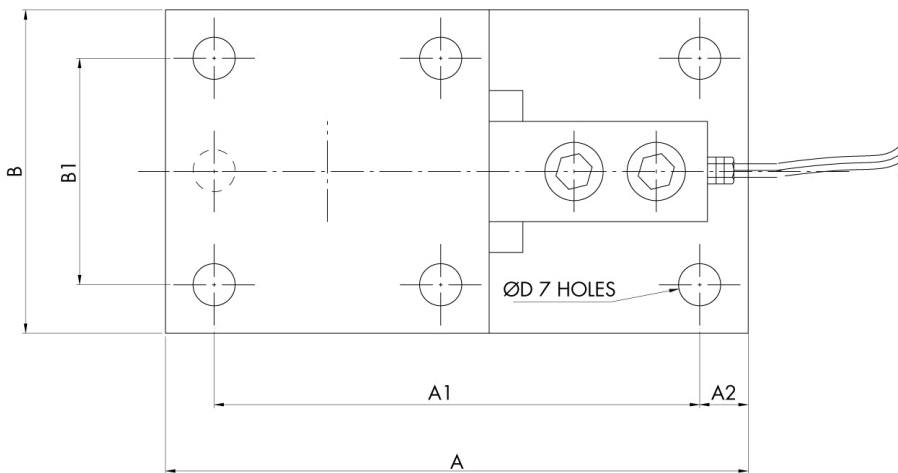
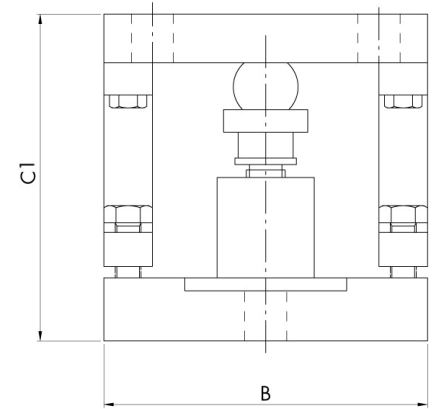
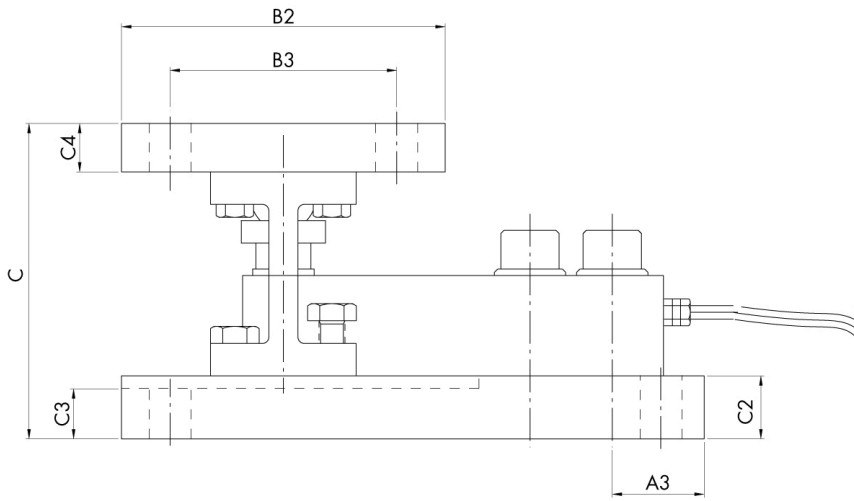
STAINLESS STEEL (capacity, dimensions and maximum load values by model)

| KIT | KG | A | A1 | A2 | A3 | B | B1 | B2 | B3 | C | C1 | C2 | C3 | C4 | ØD | COMPRESSION | TILT | SIDE LOAD |
|------|------------|-----|-----|----|------|-----|-----|-----|-----|-------|-------|------|------|------|----|-------------|----------|-----------|
| MK0 | 75÷250 | 180 | 150 | 15 | 28,4 | 100 | 70 | 100 | 70 | 97,5 | 100,5 | 19,5 | 15,5 | 15 | 13 | 9420 kg | 5970 kg | 1880 kg |
| MK1 | 75÷250 | 180 | 150 | 15 | 28,4 | 100 | 70 | 100 | 70 | 97,5 | 100,5 | 19,5 | 15,5 | 15 | 13 | 9420 kg | 5970 kg | 1880 kg |
| MK2 | 300÷2000 | 180 | 150 | 15 | 28,4 | 100 | 70 | 100 | 70 | 97,5 | 100,5 | 19,5 | 15,5 | 15 | 13 | 9420 kg | 5970 kg | 1880 kg |
| MK3 | 3000÷5000 | 250 | 210 | 20 | 41,6 | 150 | 110 | 150 | 110 | 136,5 | 140 | 29,5 | 24,5 | 20 | 18 | 21840 kg | 16460 kg | 5130 kg |
| MK4 | 3000÷5000 | 250 | 210 | 20 | 41,6 | 150 | 110 | 150 | 110 | 146,5 | 150 | 29,5 | 24,5 | 20 | 18 | 21840 kg | 16460 kg | 5130 kg |
| MK6 | 5÷500 | 180 | 150 | 15 | 30 | 100 | 70 | 100 | 70 | 97,5 | 100,5 | 19,5 | 13,5 | 15 | 13 | 5780 kg | 3750 kg | 1410 kg |
| MK7 | 15÷1500 | 180 | 150 | 15 | 22,5 | 100 | 70 | 100 | 70 | 97,5 | 100,5 | 19,5 | 8,5 | 15 | 13 | 5780 kg | 3750 kg | 1410 kg |
| MK10 | 7500÷10000 | 300 | 260 | 20 | 28,3 | 200 | 160 | 200 | 160 | 184 | 190 | 39,5 | 39,5 | 24,5 | 22 | 34200 kg | 23900 kg | 10200 kg |

All indicated data may be changed without notice.
All the measures indicated are expressed in millimeters (mm).